

4A-BF2-V(OPEN CAP)

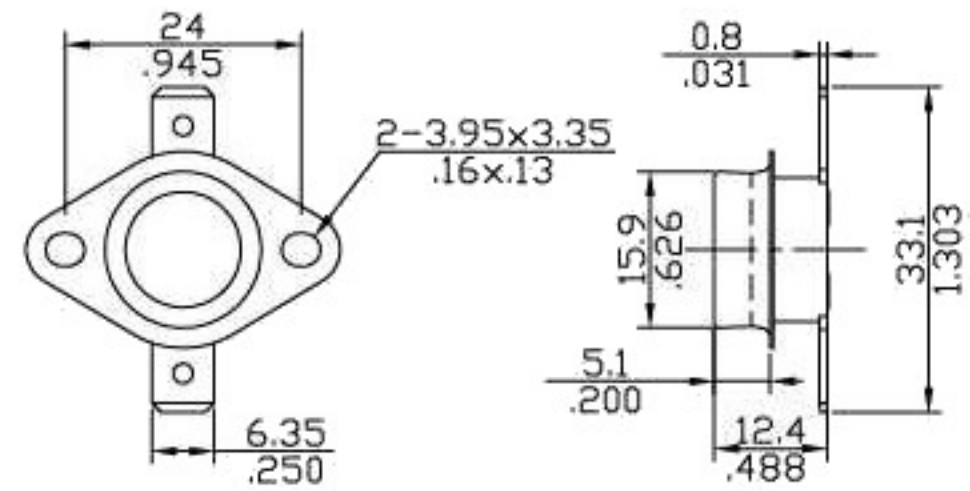

mm
Inch

Reset Type	Automatic or Manual
Contact Type on Rise	NC
Electrical Rating	16A/250VAC 15A/125VAC 10A/250VAC
Calibration Method	1°C/min, Air circulation furnace
Operating Temp. *	40°C~ 200°C (ENEC) 40°C~ 205°C (UL/CUL)
Temp. Tolerance	±3K/ ±5K
Heat Durability	180°C * 2Hr Max.
Action Temperature	70±3°C
Reset Temperature	58±4°C
Circuit Resistance	50 MΩ Max.
Insulation Resistance	100MΩ at DC 500V
Dielectric Strength	AC 1000V/min or AC 1800/sec (Leak Current 0.5mA)
Operating Life	100,000 Cycles (15A/125VAC, 10A/ 250VAC) 10,000 Cycles (16A/250VAC)

* Action temp. and reset temp. can be set up depend on customer's request