

SPECIFICATION

MAX. CURRENT/VOLTAGE RATING WITH RESISTIVE LOAD :

400mA 32VAC - 200 mA 50VDC - 125 mA 125VAC.

INITIAL CONTACT RESISTANCE : 100mΩmax.

※When the switches with the wire assembly,we only test the electric conduction and will not test the contact resistance on the wire.

INSULATION RESISTANCE : 1GΩmin.at 500VDC.

DIELECTRIC STRENGTH : 1,500 VAC rms.

ELECTRICAL LIFE AT FULL LOAD : 500,000 cycles.

OPERATING TEMPERATURE : -30°C to 85°C.

PANEL THICKNESS : 1.5 mm (.059) min. -4 mm (.157) max.

TOTAL TRAVEL : 1.5 mm(.059)

OPERATING FORCE : 3N~6N

CONTACT BOUNCE : 10 ms.

MECHANICAL LIFE : 1,000,000 cycles.

TORQUE : 0.5 Nm max.applied to nut

DEGREE OF PROTECITON: IP68

MANUAL SOLDERING:

Use soldering iron of 30 watts, controlled at 350°C approximately 5 seconds while applying solder.

WAVE SOLDERING:

Recommended Soldering Temperature: 260 ± 5°C

※ Ambient temperature of the soldered Surface of PC board.110°C Max.

Duration of Solder Immersion: Max 5 sec.(PCB is 1.6mm in thickness)



IP 68 for the whole series:

Protected against the effects of immersion up to 1 m water(60min)

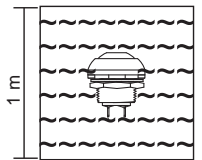

MATERIALS

CAP: Polyamide 6/6.

PLUNGER: PFS6:PC / PFS7:Polyamide 6/6.

RUBBER: Silicone.

BUSHING: Polyamide 6/6.

CASE: Diallyl phthalate (DAP)(UL94v-0).

TERMINAL/CONTACTS:Gold over silver plated.

Multi-wire lead AWG20,section 0.6mm²,UL approved

HOW TO ORDER

PF

Model NO. _____

PFS6 SP Off-Mom.

PFS7 SP On-Mom.(Without LED)

Bushing _____

B2 Threaded bushing

Cap Color _____

0 **M** Flat,Matte

A **S** Round,Bright(Non-LED)

G **S** High,Bright(Non-LED)

* Only flat cap available with LED.

| CAP COLOR | ITEM NO. | | |
|-------------|----------|--------|--------|
| | Matte | Bright | Bright |
| White | 01M | A1S | G1S |
| Black (Std) | 02M | A2S | G2S |
| Red (Std) | 03M | A3S | G3S |
| Yellow | 05M | A5S | G5S |
| Green | 06M | A6S | G6S |
| Blue | 07M | A7S | G7S |

* Besides standard color, other colors need to check stocks available.

Terminations _____

M1 Solder lug(STD)

Wire

S001 500mm leads cylinder(PFS6 only)

S002 90mm leads cylinder,stripping wire(PFS6 only)

S003 100mm leads cylinder(PFS6 only)

Y001 500mm leads heat shrink

Y002 90mm leads heat shrink,stripping wire

Y003 100mm leads heat shrink

LED Color

| ITEM NO | COLOR |
|---------|-------------|
| L00 | Without LED |
| L01 | White |
| L03 | Red |
| L05 | Yellow |
| L06 | Green |
| L07 | Blue |

Additional hardware

05 Additional hardware

* See page 2

RoHS soldering

S Rohs & Lead Free

Seal

A Sealed (STD)

Contact material

C Gold over silver

EXAMPLE:

PFS6B202MM1CAS05L03-S001

└ Wire code

SWITCH FUNCTION

| NO. POLES | MODEL NO. | SWITCH FUNCTION | | CONNECTED TERMINALS / SCHEMATIC | |
|-----------|-----------|-----------------|----------|---------------------------------|-------|
| | | POS.1 | POS.2 | POS.1 | POS.2 |
| | | | | | |
| SP | PFS6 | OFF | MOM(ON) | OPEN | CLOSE |
| SP | PFS7 | ON | MOM(OFF) | CLOSE | OPEN |

MOM=MOMENTARY

BUSHING

B2

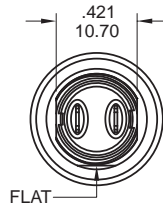
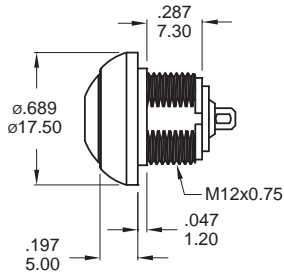

PANEL CUT-OUT

THICKNESS: 1.5 mm ~ 4.0 mm

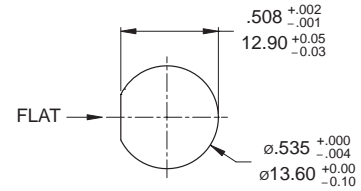

CAP OPTIONS

FLAT

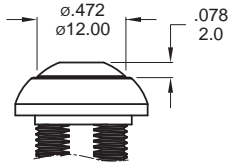

ROUND Non-LED

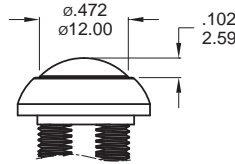

HIGH Non-LED

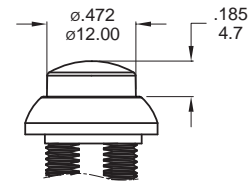

WIRE OPTIONS

SXXX Only for model type PFS6

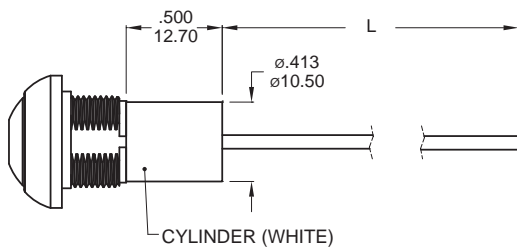

WIRE LENGTH

| CODE | DIM "L" |
|--------|-------------------|
| S001 | 500±10(19.7±.394) |
| S002 * | 90±5(3.54±.197) |
| S003 | 100±5(3.94±.197) |
| Y001 | 500±10(19.7±.394) |
| Y002 * | 90±5(3.54±.197) |
| Y003 | 100±5(3.94±.197) |



* Stripping wire for code S002 and Y002.

※ Multi-wire lead AWG20, section 0.6mm², UL approved.

YXXX

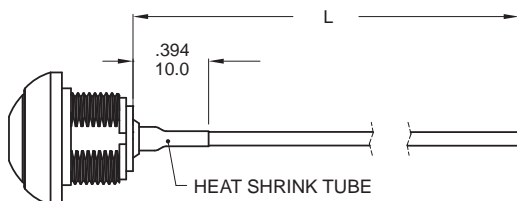

Non-LED

| DESCRIPTION | WIRE COLOR |
|-------------|------------|
| TERMINAL 1 | BLACK |
| TERMINAL 2 | BLACK |

With LED

| DESCRIPTION | WIRE COLOR |
|-------------|------------|
| TERMINAL 1 | BLACK |
| TERMINAL 2 | BLACK |
| LED+ | RED |
| LED- | GREEN |