

## SPECIFICATION

- Electrical Rating : 10A 250VAC/15A 125VAC(UL)  
10(4)A 250VAC(VDE)
- Degree of protect: IP22
- Mechanical life: Over 30000 cycles
- Electrical life: Over 10000 cycles
- Contact resistance: <math><20m\Omega</math>
- Insulation resistance: >1000M $\Omega$
- High voltage resistance: >1500V 1 min.
- Ambient temperature: Terminal side -20 to +85°C  
Actuating side -20 to +55°C
- Storage temperature: -30 to +80°C Max
- Atmospheric humidity: Max.85%
- Actuating force: 4~8N(depends on different switch function)
- Flammability: 94V-2
- Temperature rise at the terminal: Max 30°C (UL1054)
- Solder ability of terminal: Max 350°C , 3s

## MATERIALS

- Housing: PA66
- Rocker: PA66
- Contacts: Silver alloy
- Terminal: Brass silver plated
- Lamp: Neon Lamp, Tungsten Lamp
- Spring: SWC
- Movable Arm: Brass silver plated
- Bracket: PA66

## HOW TO ORDER

RAWP

Series

Series

1

Switch Function

1	ON-OFF
2	ON-ON

K

Housing Color

G	Gray
W	White
K	Black

K

Actuator Color

G	Gray
W	White
K	Black
O	Orange
R	Red
B	Blue

E

Marking

Please see option of marking

T

Terminal Type

T Connect tab 3.7(Wide)\*0.4(Thick)

C

Safety Approval

C	4 Safety Approvals
E	None Approvals

## Option of switch function

Item NO	POLES & THROWS	Rocker position		
		Left	Center	Right
RAWP1	SPST	ON	None	OFF
RAWP2	SPDT	ON	None	ON

## Dimension

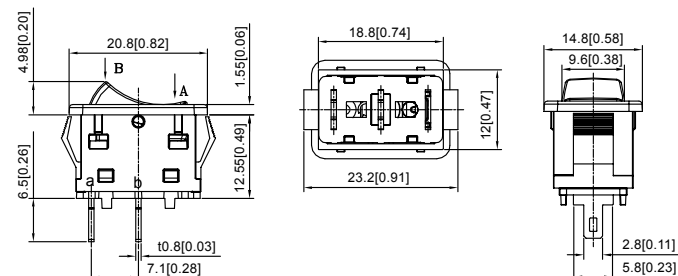

## Panel cut out

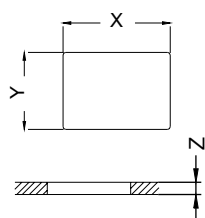

Z	Y	X
0.70~1.25	12.80~12.90	19.20~19.30
1.25~2.00	12.80~12.90	19.30~19.40
2.00~3.00	12.80~12.90	19.50~19.60