

SS12F29

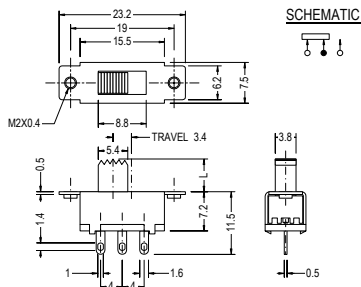
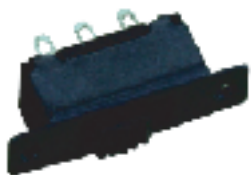

SPECIFICATION

- Circuit : ON-ON (1P2T)
- Rating : D.C. 50V 0.5A
- Contact R.[max] : D.C. 5V 1A 30m
- Insulation R.[min]: D.C. 500V 100M
- Withstand VOL. : A.C. 500V 1minute
- Operating force : 300 100g
- Timing : Non Shorting
- Life cycle[max] : 10,000 CYCLES

SS12F41



ON-ON(1P2T)

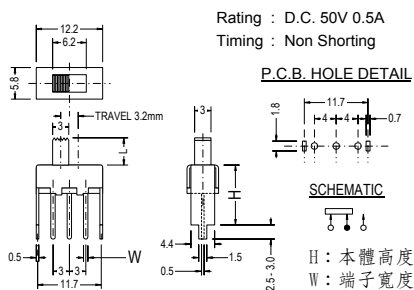

開關型號	高度(H)	端子(W)
SS-12F24	14	1.3
SS-12F41	11	0.8
SS-12F42	14	0.8
SS-12F44	6	1.2
SS-12F46	6	0.8
SS-12F49	9	0.8
SS-12F65	5.5	0.8
SS-12F68	8	0.8

SS12F55

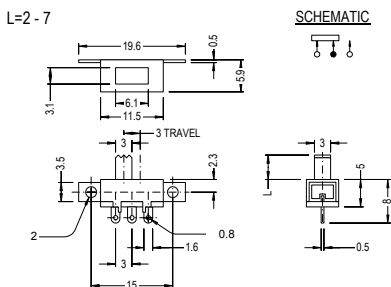

SPECIFICATION

- Circuit : ON-ON (1P2T)
- Rating : D.C. 50V 0.5A
- Contact R.[max] : D.C. 5V 1A 30m
- Insulation R.[min]: D.C. 500V 100M
- Withstand VOL. : A.C. 500V 1minute
- Operating force : 300 100g
- Timing : Non Shorting
- Life cycle[max] : 10,000 CYCLES

SS12F58



(SS-002A)

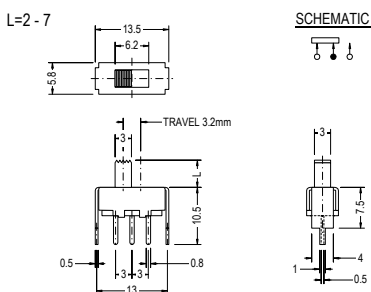

SPECIFICATION

- Circuit : ON-ON(1P2T)
- Rating : D.C. 50V 0.5A
- Timing : Non Shorting

P.C.B. HOLE DETAIL

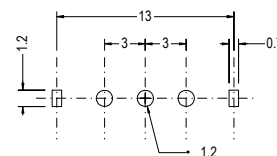

SS12F77



(SS-001A)

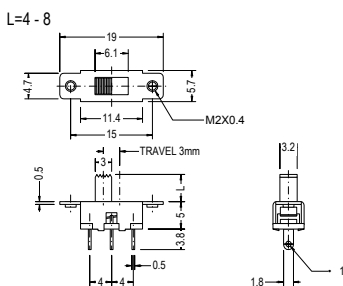

SPECIFICATION

- Circuit : ON-ON (1P2T)
- Rating : D.C. 50V 0.5A
- Contact R.[max] : D.C. 5V 1A 30m
- Insulation R.[min]: D.C. 500V 100M
- Withstand VOL. : A.C. 500V 1minute
- Operating force : 300 100g
- Timing : Non Shorting
- Life cycle[max] : 10,000 CYCLES